

Coach House[®] Motorhomes



**SCAN THIS
CODE TO
LEARN MORE**

COACHHOUSERV.COM | 941-485-0984 OR TOLL FREE 1-800-235-0984

FAMILY-OWNED AND MADE IN THE U.S.A. SINCE 1985



For nearly four decades, the Gerzeny family has been dedicated to building some of the finest motorhomes in the industry. Since 1985, when founder Ruben Gerzeny established Coach House alongside his sons David and Steven, the company has pursued one goal: to build the best small motorhomes available.

Today, that tradition continues with the next generation. David's son, Zachary, leads production with fresh ideas and forward thinking, and Steve's son, Nick, brings that same energy and innovation to sales and marketing.

***“Our goal since day one has been simple: build the best small motorhomes in the industry.”
– The Gerzeny Family***

From the beginning, Coach House has stood for quality, comfort, luxury, and reliability, always incorporating the latest technology. Our motorhomes, ranging in size from 23 to 27 feet, are designed for those who want to downsize without sacrificing freedom. Each coach is built with meticulous craftsmanship, giving you the confidence to travel knowing that care and attention to detail go into every unit.

Decades of RV manufacturing experience, a relentless quest for innovation, and a commitment to customer satisfaction are the hallmarks of Coach House. Known for their fair and honest business practices, the Gerzeny family goes the extra mile to support customers before, during, and after the sale.

At Coach House, every motorhome reflects not just engineering and design — but also the pride, dedication, and family values that have shaped our company since 1985.

INVESTED IN QUALITY WORKMANSHIP

At Coach House, every employee is invested in the success of each motorhome. Because profits are shared across the team, everyone has a stake in building quality that lasts — knowing warranty claims cut into both company and personal success. That means more time on the road and less time in a service center.

Coach House motorhomes are sold factory-direct, giving us a personal connection with every owner. Many of our best innovations come directly from customer feedback — real experiences that shape the way we build for the future.

SEEING IS BELIEVING

We invite you to do your research — and then visit our factory. Seeing the level of care that goes into every motorhome is the best way to understand what sets Coach House apart. We take great pride in our work, and we'll go the extra mile to welcome you into the growing Coach House family.

A ROCK SOLID FOUNDATION:

THE INDUSTRY'S ONLY ONE-PIECE FIBERGLASS BODY
HAND LAID AND REINFORCED WITH CARBON FIBER

IT ALL STARTS WITH A SHELL

Coach House motorhomes are renowned for their unique one-piece hand-laid fiberglass shell reinforced with carbon fiber, a standout feature that sets them apart in the RV industry.

This innovative design involves molding the entire body of the motorhome from a single piece of fiberglass, eliminating seams and joints found in traditional RV construction. The result is a highly durable and aerodynamic shell that significantly reduces the risk of leaks and water intrusion, ensuring longevity and minimal maintenance. This seamless structure also contributes to a quieter and more comfortable ride by reducing noise and vibrations.

Additionally, the one-piece fiberglass shell enhances the vehicle's structural integrity, providing superior strength and a sleek, modern appearance. Overall, this design choice reflects Coach House's commitment to quality, reliability, and craftsmanship.



Basic Two Tone Full Body Paint: Carbon



SCAN ME



PLATINUM

The Platinum 220 rides on a Ford E-450 Super Duty chassis and features a powerful 7.3-L V-8 gas engine, four-wheel disk brakes, adaptive driver aids, full fiberglass body, and a dry bath feature that doubles as a way to section the coach for bedroom privacy. With premium finishes, optimized storage, and luxurious details throughout, the Platinum blends comfort and durability in a package that balances full-size capability with highway manners.

Cabinets: Cypress



220 TB Twin beds



Scan the QR code with your smartphone's camera for more specifics including decor, image gallery, specs, features, and more!

Basic Two Tone Full Body Paint: Indigo



SCAN ME



PLATINUM III

The Platinum III 250 combines the spacious comfort of a Class B+ with nimble drivability, built on a Ford Transit 3500 chassis with a 178-inch wheelbase and powered by a 3.5L EcoBoost V-6 gas engine delivering 306 hp and 400 ft-lb of torque, mated to a 10-speed SelectShift® automatic. At 25.5 ft long, with a rear bath, well-appointed galley, generous living/storage space and premium interior materials. This coach is built for those who want luxury on the go without sacrificing ease of handling

Cabinets: Teak



250 DT
Dinette Twin



250 ST
Sofa Twin



Scan the QR code with your smartphone's camera for more specifics including decor, image gallery, specs, features, and more!

Basic One Tone Full Body Paint: Harbor

HERITAGE



SCAN ME



Introduced for our 40th anniversary, the Heritage continues to embody the craftsmanship and comfort Coach House is known for. Built on the Ford E-450 Super Duty chassis with a 7.3-L V-8 and 6-speed automatic transmission, it offers a spacious 27'4" layout with a fully equipped galley, and generous wardrobe and storage space. Inside our patented one-piece fiberglass body, you'll enjoy a quiet, solid ride paired with elegant interiors and premium cabinetry that make every trip feel special.

Cabinets: Grey Elm



H27Q Queen Bed

Seating Options:

CONVERTIBLE BED-DINETTE
(BED SIZE 34" X 69")



Dinette

SOFA BED WITH REMOVABLE TABLES
(BED SIZE 48" X 69")



Sofa



H27T Twin Bed



Scan the QR code with your smartphone's camera for more specifics including decor, image gallery, specs, features, and more!



SCAN ME

Deluxe Full Body Paint: Sterling
(Additional charge)

PLATINUM IV

261- IV



The 261-IV offers a perfect balance of maneuverability and living space, with a single slide-out that opens up a beautifully crafted interior. Built on the Ford E-450 with a 7.3-L V-8, it delivers power, comfort, and a quiet ride inside our patented one-piece fiberglass body.

Cabinets: Teak

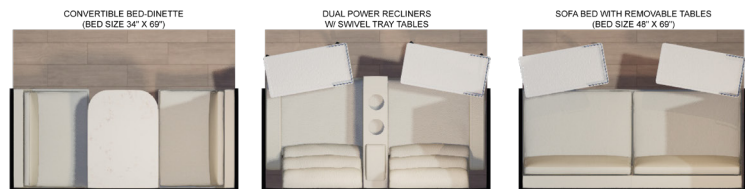

261- IV DT **261- IV RT** **261- IV ST**
Dinette Twin Recliner Twin Sofa Twin



Scan the QR code with your smartphone's camera for more specifics including decor, image gallery, specs, features, and more!

Basic Two Tone Full Body Paint: Shadow



SCAN ME



PLATINUM IV

271-IV

The 271-IV offers added versatility with a unique floorplan and slide-out design, creating a spacious lounge and sleeping area. It's large beautifully appointed galley offers generous counter space, premium finishes, and abundant storage for effortless meal preparation. Built on the dependable Ford E-450 super duty cutaway chassis and proven 7.3L V-8 engine, the 271-IV blends refined craftsmanship with reliable performance for exceptional adventures wherever your journey takes you.

Cabinets: Walnut

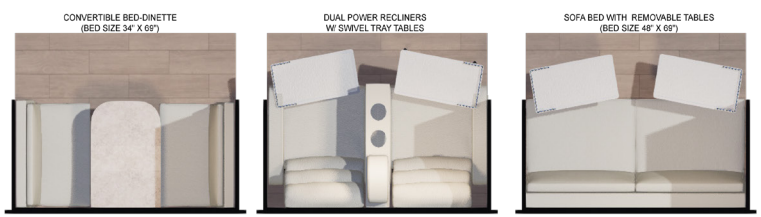
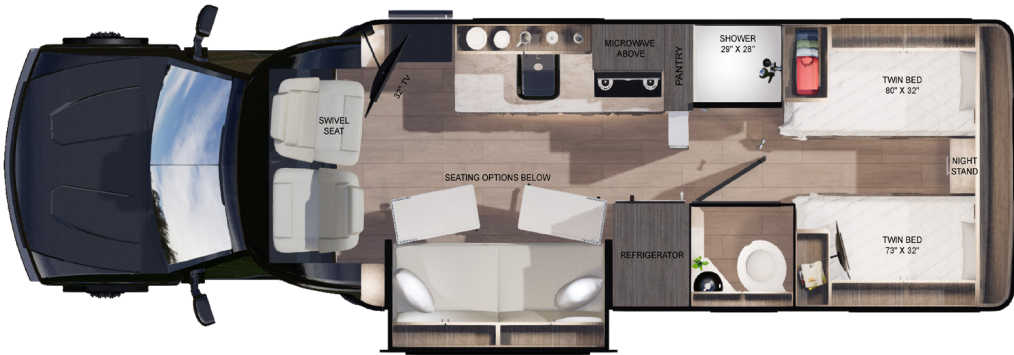

271- IV DT Dinette Twin
271- IV RT Recliner Twin
271- IV ST Sofa Twin



Scan the QR code with your smartphone's camera for more specifics including decor, image gallery, specs, features, and more!



Deluxe Full Body Paint: Sterling
(Additional charge)

SCAN ME



PLATINUM IV

272- IV

The 272-IV is our most spacious Platinum IV, featuring dual slide-outs for an open, residential feel. Enjoy premium cabinetry, solid-surface countertops, and all the luxury appointments that make every trip feel like home.

Cabinets: Forest



CONVERTIBLE BED-DINETTE
(BED SIZE 34" X 69")

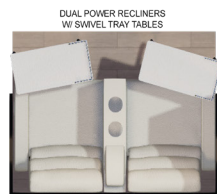

DUAL POWER RECLINERS
W/ SWIVEL TRAY TABLES



SOFA BED WITH REMOVABLE TABLES
(BED SIZE 48" X 69")

272- IV DQ **272- IV RQ** **272- IV SQ**
Dinette Queen Recliner Queen Sofa Queen



Scan the QR code with your smartphone's camera for more specifics including decor, image gallery, specs, features, and more!

Basic One Tone Full Body Paint: Ivory



SCAN ME



ARRIVA V-24

The Arriva V-24 TB redefines what a Class B can be, built on the Mercedes-Benz Sprinter 3500 diesel chassis with a 2.0-L turbocharged engine putting out ~208 hp and 332 ft-lb torque, paired with a 9-speed transmission. Despite its compact 24.17 ft length, the Arriva offers a fully enclosed bathroom with toilet and separate shower, a galley with a 8 cu. ft. refrigerator/freezer, twin beds that convert to a king, high-end finishes, and standard entertainment inside and out—luxury and convenience in a nimble footprint.

Cabinets: Teak



V-24 TB Twin Beds



Scan the QR code with your smartphone's camera for more specifics including decor, image gallery, specs, features, and more!



SCAN ME



Basic Two Tone Full Body Paint: Desert

PLATINUM II

The Platinum II remains the choice for those seeking elegance and efficiency, built on the Mercedes-Benz Sprinter 4500 chassis with a 2.0-L I-4 turbo diesel engine and 9-speed transmission. Offered in multiple floorplans—many with the XL slide-out option—it features premium finishes, generous storage, and Coach House’s signature one-piece fiberglass body reinforced with carbon fiber.

Cabinets: Cypress

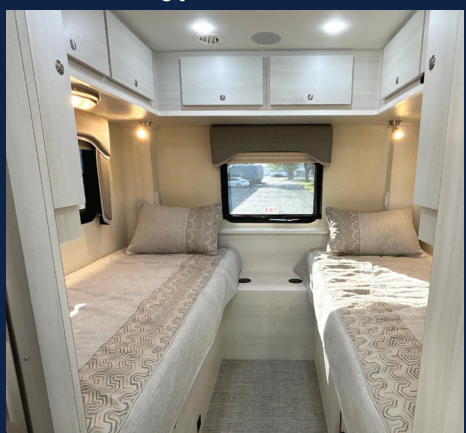

240 DQ
Dinette Queen



241XL DQ
Dinette Queen

241XL RQ
Recliner Queen

241XL SQ
Sofa Queen



240 DRT
Dinette Rear Twin



240 SRT
Sofa Rear Twin



241XL DQ
Dinette Rear Twin



241XL RQ
Recliner Rear Twin



241XL SQ
Sofa Rear Twin



Scan the QR code with your smartphone’s camera for more specifics including decor, image gallery, specs, features, and more!

COACH HOUSE MODEL SPECS AND FEATURES

Interior	220	240	241XL	250	261-IV	271-IV	272-IV	H27	V24
Forest, Walnut, Teak, Grey Elm, Cypress	S	S	S	S	S	S	S	S	S
Large overhead and wardrobe storage	S	S	S	S	S	S	S	S	S
Solid-surface counter tops	S	S	S	S	S	S	S	S	S
Flat-panel HD TV w/ swing arm (sizes vary)	S	S	S	S	S	S	S	S	S
MCD day/night shade system	S	S	S	S	S	S	S	S	S
Premium floors	S	S	S	S	S	S	S	S	S
Medicine cabinet	S	S	S	S	S	S	S	S	S
Separate toilet/shower	S	S	S	S	S	S	S	S	S
Textured flooring	O	O	O	O	O	O	O	S	O
Hybrid Mattresses	S	S	S	S	S	S	S	S	S
Sound bar for front TV	O	O	O	O	O	O	O	O	-
Flat-panel HD TV in bedroom (some models)	O	O	O	O	O	O	O	O	S
Theater-style recliners	-	-	O	-	O	O	O	-	-
Side and rear entry screen door package	-	-	-	-	-	-	-	-	S

Exterior	220	240	241XL	250	261-IV	271-IV	272-IV	H27	V24
Patented one-piece fiberglass body with carbon-fiber reinforcement	S	S	S	S	S	S	S	S	-
Electric entry step with light	S	S	S	S	S	S	S	S	-
HD TV antenna / with Wi-Fi	S	S	S	S	S	S	S	S	S
Heavy duty trailer hitch-receiver	S	S	S	S	S	S	S	S	S
Exterior fiberglass storage compartments	S	S	S	S	S	S	S	S	S
1.5-inch square-tube Aircraft Grade aluminum floor frame	S	-	-	S	S	S	S	S	-
4-inch channel aluminum floor frame	-	S	S	-	-	-	-	-	-
Stainless steel wheel simulators	S	S	S	-	S	S	S	S	S

Exterior (Continued)	220	240	241XL	250	261-IV	271-IV	272-IV	H27	V24
Exterior hot and cold shower	S	S	S	S	S	S	S	S	S
Full-size heavy duty side entry door with screen	S	S	S	S	S	S	S	S	-
Cable TV Connection	S	S	S	S	S	S	S	S	S
HWH hydraulic slideout (2 in some models)	-	-	S	-	S	S	S	S	-
Automatic hydraulic leveling system	O	O	O	O	S	S	S	O	-
MOR/ryde rear suspension	-	-	-	-	S	S	S	S	-
Frameless jalousie windows	S	S	S	S	S	S	S	S	-
Rear protective skid wheels	S	S	S	S	S	S	S	S	S
Legless power awning w/ LED lights	S	S	S	S	S	S	S	S	S
Safety-Plus	S	-	-	-	S	S	S	S	-
Alcoa aluminum rims (4)	O	O	O	-	O	O	O	O	O
Basic Single full-body paint	S	S	S	S	S	S	S	-	-
Basic two-tone full-body paint	S	S	S	S	S	S	S	-	-
Full-body paint (Deluxe)	O	O	O	O	O	O	O	-	-

Galley	220	240	241XL	250	261-IV	271-IV	272-IV	H27	V24
Two or three burner LP gas stove (see floor plans)	S	S	S	S	S	S	S	S	S
Single or Dual Induction Stove (depends on model)	O	O	O	O	O	O	O	O	O
Stainless steel range hood	S	S	S	S	S	S	S	S	-
Stainless convection/microwave oven	S	S	S	S	S	S	S	S	S
Recessed stainless kitchen sink w/cover	S	S	S	S	S	S	S	S	S
2-way AC/LPG absorption refrigerator	S	S	S	S	S	S	S	S	S
2-way AC/DC compressor refrigerator	O	O	O	O	O	O	O	O	O
Spacious pantry (n/a on some floorplans)	S	S	-	S	S	S	S	S	S

Tank Capacity	220	240	241XL	250	261-IV	271-IV	272-IV	H27	V24
Fuel Tank (gallons)	55	26.4	26.4	31	55	55	55	55	26.4
Fresh water tank (gallons)	25	24	24	25	24	40	40	24	24
Grey water tank (gallons)	28	28	28	19	27	27	27	27	20
Black water tank (gallons)	27	25	25	28	25	25	25	25	13
Propane tank (pounds/gallons)	68/18	68/18	68/18	55/16	68/18	68/18	68/18	68/18	55/16

Electrical	220	240	241XL	250	261-IV	271-IV	272-IV	H27	V24
110v/12v 45-amp converter	S	S	S	S	S	S	S	S	S
Ample 110v outlets (some with USB and USB-C)	S	S	S	S	S	S	S	S	S
4.0kw generator	S	-	-	S	S	S	S	S	-
3.6kw LPG generator	-	S	S	-	-	-	-	-	S
Interior and exterior LED lighting	S	S	S	S	S	S	S	S	S
Carbon monoxide, LP gas, and smoke detectors	S	S	S	S	S	S	S	S	S
Emergency start switch	S	S	S	S	S	S	S	S	S
Hybrid RV Conversion	S	S	S	S	S	S	S	S	S
Auxiliary battery disconnect	S	S	S	S	S	S	S	S	S
25-foot shore power cord	S	S	S	S	S	S	S	S	S
Exterior 110v outlet	S	S	S	S	S	S	S	S	S
Porch, compartment, and entry lights	S	S	S	S	S	S	S	S	S
Navigation system	S	S	S	S	S	S	S	S	S
3000 Watt pure sine wave inverter	S	S	S	S	S	S	S	S	S
Color back-up video camera and monitor	S	S	S	S	S	S	S	S	S
XM/Sirius satellite radio-ready	S	S	S	S	S	S	S	S	S
Auto start generator	S	S	S	S	S	S	S	S	S
200-watt solar battery charger	S	S	S	S	S	S	S	S	S
Reliable yet sleek analog switching with backlight panel	S	S	S	S	S	S	S	S	S
1 additional 200 watt solar battery charger	O	O	O	O	O	O	O	O	-
In-motion satellite system with receiver (Dish or Direct)	O	O	O	O	O	O	O	O	O
Wireless cell phone chargers	S	S	S	S	S	S	S	S	-

Heating & Cooling	220	240	241XL	250	261-IV	271-IV	272-IV	H27	V24
15,000-Btu ducted roof air conditioner with heat pump	S	S	S	S	S	S	S	S	S
15,000-Btu Truma Ducted A/C without Heat Pump	O	O	O	O	O	O	O	O	O
30,000-Btu auto LP gas furnace (19,000 BTU Arriva)	S	S	S	S	S	S	S	S	S
Two power roof vents with covers	S	S	S	S	S	S	S	S	S(1)
Heavy-duty insulation	S	S	S	S	S	S	S	S	S
Heated holding tanks	S	S	S	S	S	S	S	S	S

Dimensions	220	240	241XL	250	261-IV	271-IV	272-IV	H27	V24
Wheelbase	158"	170"	170"	178"	176"	176"	176"	176"	170"
Overall length	23' 2"	25' 9"	25' 9"	25' 6"	27' 8"	27' 8"	27' 8"	26' 10"	24' 2"
Overall width	8' 0"	8' 0"	8' 0"	8' 0"	8' 0"	8' 0"	8' 0"	8' 0"	6' 6.5"
Overall width with slide-out(s) extended	-	-	10'	-	10' 4"	10' 4"	12' 5"	-	-
Overall height including A/C	10' 5"	10' 7"	10' 7"	10' 5"	10' 7"	10' 7"	10' 7"	10' 7"	9' 7"
Interior headroom	6' 3"	6' 4"	6' 4"	6' 4"	6' 6"	6' 6"	6' 6"	6' 3"	6' 2"
GVWR (maximum weight of loaded vehicle) (pounds)	14,500	12,125	12,125	11,000	14,500	14,500	14,500	14,500	11,030
GCWR (maximum weight of loaded vehicle plus tow) (pounds)	22,000	15,250	15,250	15,000	22,000	22,000	22,000	22,000	15,250
Rear axle ratio	4.56:1	4.18:1	4.18:1	3.73:1	4.56:1	4.56:1	4.56:1	4.56:1	3.92:1
Interior storage (cu. ft.; varies by floor plan)	48	52	52	52	75.4	70.2	71.8	70.2	NA
Exterior storage (varies by floor plan)	13.5	22.7	22.7	23	29.3	29.3	29.3	29.3	NA

Plumbing	220	240	241XL	250	261-IV	271-IV	272-IV	H27	V24
4 Season all-weather interior plumbing	S	S	S	S	S	S	S	S	S
Large propane tank	S	S	S	S	S	S	S	S	S
External quick disconnect for LPG grill	S	S	S	S	S	S	S	S	S
On-demand propane water heater	S	S	S	S	S	S	S	S	S
Porcelain flush toilet	-	-	-	S	S	S	S	-	S
Macerator Toilets	S	S	S	-	-	-	-	S	-
Demand fresh water system	S	S	S	S	S	S	S	S	S
City water connection	S	S	S	S	S	S	S	S	S
Black Water Flush	S	S	S	S	S	S	S	S	S
Universal utility compartment	S	S	S	S	S	S	S	S	S

Features and options subject to change without notice. Images pictured may show added features that do not come standard. Please contact a Coach House RV representative for further details.



YOUR NEXT ADVENTURE STARTS HERE.

Scan to explore more models, watch video tours, and discover what makes our hand-crafted motorhomes a trusted choice for your journeys.



FORD E-450 CHASSIS FEATURES - FORD QVM (QUALITY VEHICLE MANUFACTURER CERTIFIED)

Ford E-450 Super Duty Chassis are used for our Heritage, Platinum, and Platinum IV lineups. They are powered with 7.3-liter V-8 engine with 350 HP and 468ft-lbs of Torque; automatic 6-speed transmission with tow/haul mode; power steering; automatic emergency braking; distance alert/distance indication; automatic collision avoidance; adaptive cruise control; lane departure warning; driver alert system; auto-high beam control; power windows; power door locks; keyless remote entry; power side mirrors; 55-gallon fuel tank; 4-wheel anti lock disc brakes; air conditioning; tilt steering wheel; intermittent wipers; front chrome bumper and grill; driver and passenger airbags; navigation system; XM/Sirius ready; color backup camera; tire pressure monitoring system and more!

FORD TRANSIT CHASSIS FEATURES (QUALITY VEHICLE MANUFACTURER CERTIFIED)

Ford Transit 3500 (178" wheelbase) with 3.5-liter V-6 Ecoboost gasoline engine rated at 310 horsepower and 400 foot-pounds of torque, 10-speed automatic transmission, all-wheel drive, cruise control, power door locks, illuminated sun visors, chrome exterior package, trailer tow package, chrome wheels, Sync 4 radio system, lane-keeping alert, leather steering wheel, auto lamps with rain-sensing, keyless entry, air bags and much more.

MERCEDES-BENZ SPRINTER CHASSIS FEATURES (EXPERT UPFITTER)

The Mercedes-Benz Sprinter 3500 and 4500 chassis both offer impressive performance and refinement. The 3500 features an optional AWD system that enhances steering feel, maneuverability, and ground clearance, while the 4500 delivers the same driving comfort and power in a rear-wheel-drive configuration with added overall capacity. Both are equipped with 170-inch wheelbase, an efficient 4-cylinder engine portfolio, and a high-output diesel engine producing 208 horsepower and 332 lb-ft of torque. Paired with the 9G-TRONIC transmission, drivers can expect smoother shifting, improved efficiency, and reduced noise levels for a quiet, confident ride.

Features and options subject to change without notice. Images pictured may show added features that do not come standard. Please contact a Coach House RV representative for further details.



DESIGN CENTER

Every model features a full-body custom paint finish, paired with designer fabrics and premium interior surfaces.

Available Paint for the Coach House Platinum

Basic Single Paint (Included):



Harbor



Dune



Two Tone Paint (Included):



Shadow



Desert



Carbon



Indigo



Deluxe Paint (Additional Charge):



Sterling



Sunset

Available
Paint for the
Coach House
Arriva



Ivory



Tenorite Grey

CABINETY

TEAK



CYPRESS



WALNUT



GREY ELM



FOREST





PEACE OF MIND — GUARANTEED

We are proud of our good reputation, which is due in part to our warranty policy. To sum it up, we stand behind our customers and products. Every component of Coach House is covered by a warranty: The conversion and the chassis are covered for 3 years or 36,000 miles, whichever comes first, while the driveline and powertrain maintain the manufacturer's warranty. The appliances and fixtures are covered by their respective manufacturers for varying terms. Warranty service is available nationwide at the repair facility of your choice, or at the Coach House plant in Nokomis, Florida.

BUY FACTORY-DIRECT AND SAVE!

Coach House® motorhomes are sold only at our factory near Venice, Florida. The Coach House Buying Experience includes numerous buyer incentives, including a “Buy- n-Fly” program, personal factory tours, generous trade-in allowances, on-the-spot financing for qualified buyers, and detailed instruction how to operate and care for your RV. No middlemen, no pressure, no gimmicks — it's a great way to buy a motorhome. Remember, our vehicles are warrantied throughout North America. Call to find out more.



941-485-0984 | 1-800-235-0984 Toll-free | coachhouserv.com
3480 Technology Drive Nokomis, Florida 34275